

1 OHD HEADER DETAIL
SCALE: 1 1/2"=1'-0"

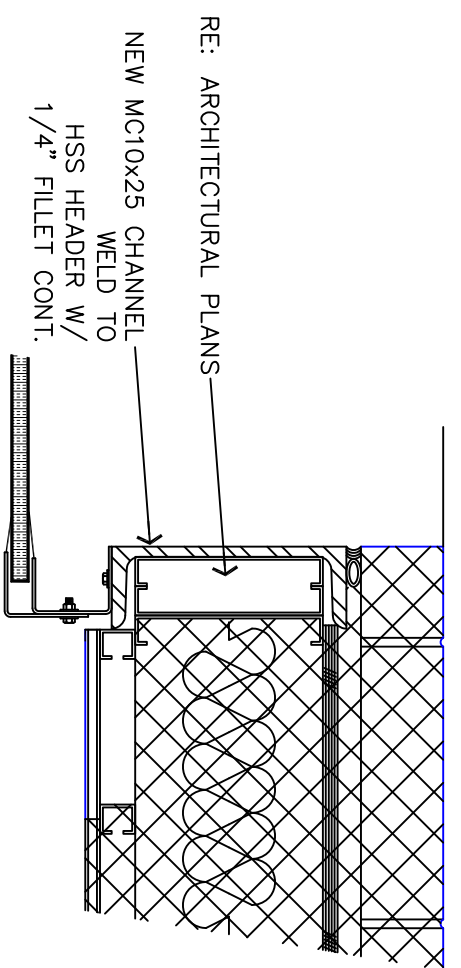

2 JAMB SUPPORT DETAIL
SCALE: 1 1/2"=1'-0"

- DESIGN LOADS**
- ROOF LIVE LOAD 20 psf
 - ROOF SNOW LOAD (DRIFTING ADDITIONAL) .. 20 psf
 - GROUND SNOW LOAD 20 psf
 - FLAT ROOF SNOW LOAD 20 psf
 - SNOW EXPOSURE FACTOR 1.0
 - SNOW IMPACTANCE FACTOR 1.0
 - THERMAL FACTOR 1.0
 - WIND SPEED (3 SEC GUST) 90 mph
 - WIND IMPORTANCE FACTOR 1.0
 - WIND EXPOSURE B
 - WIND INTERNAL PRESSURE COEFFICIENT +/-0.18
 - SEISMIC IMPORTANCE FACTOR 1.0
 - SEISMIC RESPONSE ACCELERATION (Sa, S1) .. 12.50, 6.00
 - SEISMIC DESIGN CATEGORY D
 - SEISMIC ANALYSIS PROCEDURE EQUIVALENT LATERAL FORCE
- DESIGN NOTES**
- ALL DESIGN WORK FOR THIS PROJECT SHALL CONFORM TO THE 2006 INTERNATIONAL BUILDING CODE (IBC).
 - SHOP DRAWINGS SHALL BE SUBMITTED FOR REVIEW BY THE ENGINEER PRIOR TO FABRICATION.
 - THE GENERAL CONTRACTOR SHALL PROVIDE ADEQUATE SHORING OR BRACING DURING CONSTRUCTION TO RESIST FORCES SUCH AS WIND AND UNBALANCED LOADING DURING CONSTRUCTION.
- CONCRETE NOTES**
- ALL CONCRETE WORK SHALL CONFORM TO THE AMERICAN CONCRETE INSTITUTE STANDARD BUILDING CODE REQUIREMENTS FOR REINFORCED CONCRETE (ACI 318-02) AND THE LATEST APPLICABLE RECOMMENDATIONS OF THE ACI MANUAL OF STANDARD PRACTICE.
 - CEMENT SHALL CONFORM WITH ASTM C150 TYPE 1 or II.
 - AGGREGATE SHALL CONFORM WITH ASTM C33.
 - WATER FOR MIX SHALL BE FORTH FOR FOOTINGS AND FOUNDATIONS SHALL BE FORTH FOR CONCRETE.
 - HAVE A MINIMUM COMPRESSIVE STRENGTH AT 28 DAYS OF 3000 PSI UNLESS NOTED OTHERWISE IN THE SPECIFICATIONS PROVIDE CONCRETE WITH 4" +/- 1" SLUMP.
 - ALL EXPOSED EXTERIOR CONCRETE WORK SHALL CONTAIN 5% TO 7% AIR ENTRAINMENT.
 - CHLORIDES IN ANY FORM OR CONCENTRATION SHALL NOT BE ADDED TO ANY CONCRETE.
- REINFORCING STEEL**
- ALL REINFORCING STEEL SHALL BE ASTM A615 GRADE 60.
 - ALL WELDED WIRE FABRIC SHALL BE ASTM A195 COLD DRAWN WIRE. LAP 1 MESH SPACING MINIMUM AT ALL SPLICES.
 - ACCESSORIES SHALL BE AS SPECIFIED IN THE LATEST EDITION OF CONCRETE REINFORCING STEEL INSTITUTE DESIGN HANDBOOK "PLACING REINFORCING BARS".
 - LOCATE AND SUPPORT REINFORCING BY METAL CHAIRS, RUNNERS, BOLSTERS, SPACERS, AND HANGERS, AS REQUIRED TO SECURE AGAINST DISPLACEMENT.
 - MAXIMUM ACCESSORY SPACING SHALL BE 4'-0" ON CENTER.
 - CONTACT LAP SPLICES FOR REINFORCING BARS SHALL BE 24" FOR #4 BARS.
- CAST-IN-PLACE CONCRETE EXECUTION**
- ALL CONCRETE IS REINFORCED UNLESS SPECIFICALLY NOTED AS UNREINFORCED. REINFORCE ALL CONCRETE NOT OTHERWISE SHOWN WITH SAME STEEL AS SIMILAR SECTION.
 - COMPLY WITH ACI 304, RECOMMENDED PRACTICE FOR MEASURING, MIXING, TRANSPORTING, AND PLACING CONCRETE.
 - COLD WEATHER CONDITIONS: WHEN AIR TEMPERATURE HAS FALLEN TO OR IS EXPECTED TO FALL BELOW 32°F, CONCRETE REINFORCEMENT SHALL BE COVERED WITH PROVISIONS OF ACI 306 AND 308. ALL REINFORCING SHALL BE PROTECTED FROM PHYSICAL DAMAGE OR REDUCED STRENGTH THAT COULD BE CAUSED BY FROST, FREEZING ACTIONS, OR LOW TEMPS.
 - HOT WEATHER CONDITIONS: WHEN AIR TEMPERATURE EXCEEDS 90 DEGREES F, ALL CONCRETE SHALL COMPLY WITH THE PROVISIONS OF ACI 305 AND HEREIN SPECIFIED.
 - ALL VERTICAL STEEL AND CONTINUOUS STEEL SHALL BE LAP SPLICED USING CLASS B SPLICES PER ACI 318, UNLESS NOTED OTHERWISE.
 - COORDINATE CONCRETE FINISHES, RECESSED AREAS, REVEALS, EMBEDDED ITEMS, SPECIAL JOINT PATTERNS, ETC. WITH THE MANUFACTURER DRAWINGS SPECIFICATIONS.
 - PROVIDE 3/4" CHAMFER AT ALL EXPOSED EDGES OF CONCRETE.
 - NO ALUMINUM ITEMS SHALL BE EMBEDDED IN CONCRETE.
 - MAINTAIN MINIMUM CONCRETE COVER FOR REINFORCING AS INDICATED BELOW UNLESS NOTED OTHERWISE ON DRAWINGS:
- A. EARTH FORMED 3"
 B. CAST AGAINST FORMS BUT EXPOSED TO EARTH/WEATHER #5 OR #6 OR GREATER 2"
 C. SLABS NOT EXPOSED TO EARTH OR WEATHER 1-1 1/2"
 D. OTHER 2"
- OTHER..... 2"**
- STRUCTURAL STEEL**
- ALL STRUCTURAL STEEL SHALL BE ASTM A56 FOR SHAPES AND PLATES, ASTM A501 FOR PIPES, ASTM A500, GRADE B FOR STRUCTURAL TUBES, UNLESS NOTED OTHERWISE.
 - FABRICATION AND ERECTION SHALL BE IN ACCORDANCE WITH THE LATEST EDITION OF AISC MANUAL OF STEEL CONSTRUCTION.
 - ALL BEAM CONNECTIONS SHALL BE WELDED OR BOLTED AS DETAIL ON THE DRAWINGS OR PER THE LATEST EDITION OF THE AMERICAN INSTITUTE OF STEEL CONSTRUCTION HANDBOOK, "FRAMED BEAM CONNECTIONS". BOLTS SHALL BE 3" DIA. A325N, TIGHTENED TO THE SNUG TIGHT CONDITION UNLESS NOTED OTHERWISE ON THE DRAWINGS.
 - ALL ANCHOR BOLTS SHALL BE ASTM A307 OR A36 UNLESS NOTED OTHERWISE. ANCHOR BOLTS WILL HAVE EITHER A HEAVY HEX HEAD OR HEAVY HEX NUT WELDED TO THE EMBEDDED END UNLESS NOTED OTHERWISE.
 - ANCHOR BOLTS SHALL BE LOCATED USING TEMPLATES AND SET IN PLACE WITH EXPOSED THREADS OF BOLTS GREASED BEFORE PLACING CONCRETE.
 - ALL WELDING SHALL CONFORM TO THE CURRENT AMERICAN WELDING SOCIETY SPECIFICATIONS AND BE PERFORMED BY CERTIFIED WELDERS.
 - ALL STRUCTURAL STEEL SHALL HAVE ONE SHOP COAT OF RUST INHIBITOR PRIMER PAINT CONFORMING TO THE SPECIFICATIONS. FIELD TOUCH UP ALL UNPAINTED, NICKED, OR WELDED AREAS.
 - PRE-ENGINEERED BUILDINGS SHALL BE IN ACCORDANCE WITH THE LATEST EDITION OF MECA STANDARDS & ASSC MANUAL OF STEEL CONSTRUCTION CALCULATIONS & SHOP DRAWINGS SHALL BE SUBMITTED FOR APPROVAL PRIOR TO RELEASE FOR FABRICATION.

- SPECIAL INSPECTIONS**
- SPECIAL INSPECTIONS AND OBSERVATIONS SHALL BE PERFORMED IN ACCORDANCE WITH CHAPTER 17 OF THE 2006 IBC. ALL SPECIAL INSPECTIONS SHALL BE QUALIFIED FOR INSPECTION OF THE PARTICULAR TYPE OF CONSTRUCTION REQUIRING SPECIAL INSPECTION AND MUST BE APPROVED BY THE BUILDING OFFICIAL. SPECIAL INSPECTIONS SHALL BE PERFORMED BY THE DULLES AND RESPONSIBILITIES OUTLINED IN CHAPTER 17 OF THE 2006 IBC. THE SPECIAL INSPECTION SHALL BE CONDUCTED BY THE ENGINEER OF RECORD OR RECORD ENGINEER OF RECORD. THE ENGINEER OF RECORD SHALL BE RESPONSIBLE FOR THE TYPES OF WORK REQUIRING SPECIAL INSPECTIONS:
 - CONCRETE PER SECTION 1704.4
 - VERIFY PLACEMENT OF REINFORCING STEEL
 - SAMPLING OF FRESH CONCRETE
 - PERFORM SLUMP TEST
 - AIR CONTENT (EXPOSED CONCRETE ONLY) AND TEMPERATURE TEST
 - CAST SPECIMENS FOR STRENGTH TEST
 - STRUCTURAL STEEL PER SECTION 1704.2 AND 1704.3
 - SHOP INSPECTION OF STRUCTURAL STEEL FABRICATION PER 1704.2 UNLESS PERFORMED IN AN APPROVED SHOP PER 1704.2.2.
 - PERIODIC INSPECTION OF BEARING TYPE BOLTED CONNECTIONS. BOLTS SHALL BE TIGHTENED TO A SNUG-TIGHT CONDITION AND OBSERVED ONCE TO ENSURE THAT ALL FILES OF CONNECTED ELEMENTS ARE BEING REMOVED AND ALL FILES OF CONNECTED ELEMENTS ARE BEING REMOVED AND ALL FILES OF CONNECTED ELEMENTS ARE BEING REMOVED.
 - QUALIFICATION OF WELDING PROCEDURE AND WELDERS SHALL BE VERIFIED PRIOR TO START OF WORK. PERIODIC INSPECTIONS SHALL BE MADE OF WORK IN PROGRESS AND VISUAL INSPECTION OF ALL WELDS SHALL BE MADE PRIOR TO COMPLETION.
 - SOILS PER SECTION 1704.7
 - VERIFICATION OF LOAD BEARING REQUIREMENTS PRIOR TO PLACEMENT OF REINFORCING STEEL AND CONCRETE IN ALL FOOTINGS AND FILL PLACEMENT UNDER SLABS ON GRADE > 24" FOR GRANULAR FILL OR > 8" FOR SOIL FILL.

Interior Tenant Finish

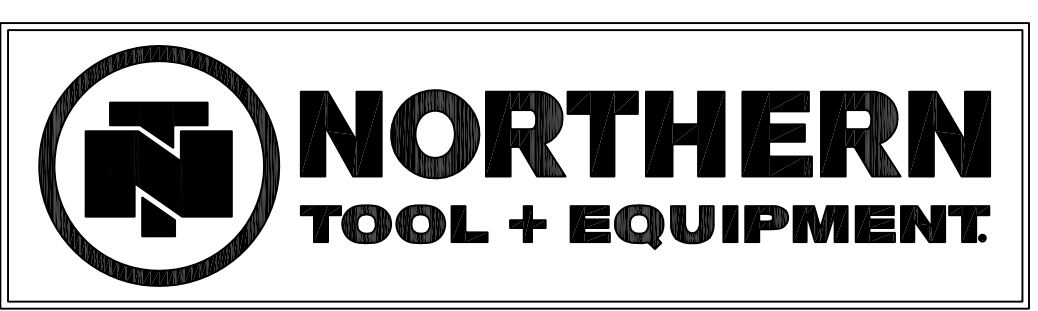

12120 West 95th Street Lenexa, Kansas 66215

THIS DOCUMENT IS ISSUED FOR BIDDING PURPOSES ONLY. THE GENERAL CONTRACTOR AND HIS GENERAL SUBCONTRACTOR SHALL BE RESPONSIBLE FOR OBTAINING ALL NECESSARY PERMITS AND APPROVED BY THE CITY OR JURISDICTION FOR CONSTRUCTION PURPOSES.

BY: HD ENGINEERING & DESIGN, INC.
 ISSUE DATE: 4 FEBRUARY 2011



Project Number: 3016
 Date: 4 FEB. 2011
 Revised: CLS
 Drawn By: CLS
 Sheet Number: S 1

STRUCTURAL PLANS
 DETAILS, & SPECS.